



# K95 Series Introduction



# Content

1

Product Definition

2

Product Selling Points

3

Product Competition Advantages

4

Product Series



01

# Product Definition

# Product Definition



Product Category

HORECA & Big office

Small & Medium office

30 ~ 50 cups



60 ~ 80 cups



**K95 Series**

NEW

100~150 cups

Planning

10 ~ 20 cups



30 ~ 50 cups



**K95 Series**

NEW

60 ~ 80 cups



Low

Medium

High

Daily Coffee Consumption



# Product Definition

---



## K95 Application Sceneries



Coffee To Go



Hotels



Contract Catering



Offices



Education



Community

- Convenient Store · Bar · Buffet · Small Comp · School · Hair Salon
- Petrol Station · Canteen · Restaurant · Middle Comp · Institution · Beauty Salon
- Bakery · Meeting Room · Lounge · Lunch Area · Colleague · Gym



# Product Definition



K95



K95L



## Technical Data

Item	Specification
Volt/Frequency	220-240V/50-60Hz
Heating power	2700 W
Pump pressure	19 Bar (two pumps, two thermo blocks)
Water tank capacity	1.8L+ tap water / 6L + tap water
Beans container capacity	1000 g
Capacity of coffee grounds container	30-35 portions (Optional auto slag-falling system with funnel)
Capacity of waste water tray	2 L (Optional drainage pipe)
Adjusting height of coffee spout	105-165mm
Length of power cord	1.5 meters
Dimensions(L*W*H)	K95: 511*303*582mm K95L: 511*390*582 mm
N.W./G.W.	17-22 KG/21-23 KG
Loading Qty.(20',40')	K95: 145/290 units; K95L: 117/246 units



02

## Product Selling Points

01

7" Colorful LCD Screen with 20+ programmable beverages





02

## Easily upload customized videos from U Disk for brand promo & Ads

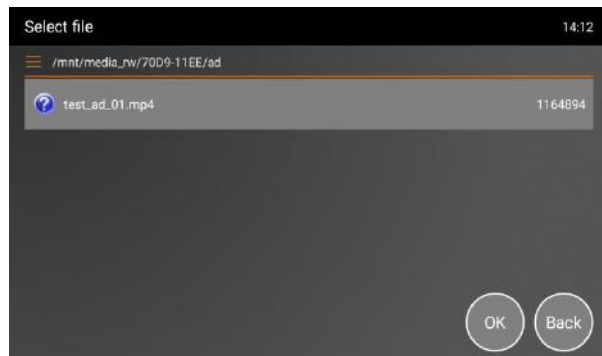
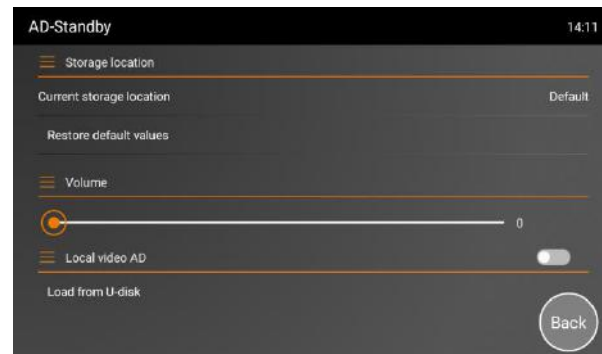
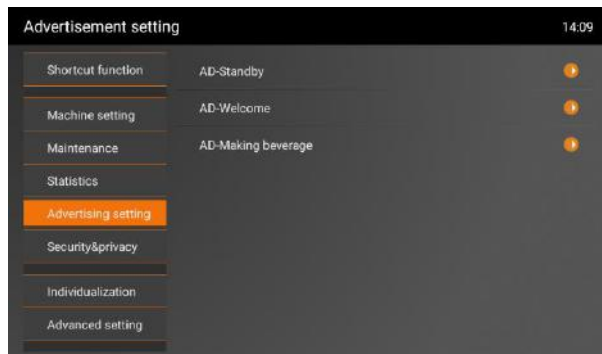

03

**High efficient milk coffee dispense system**  
**- Serving milk coffee in less than 60 seconds**



**Dual Thermo Blocks**  
**Dual Pumps**

Milk foam & Coffee come together to make  
**Cappuccino/Latte < 50s/cup**



04

## **Brew Master - Excellent brewing system for perfect espresso**

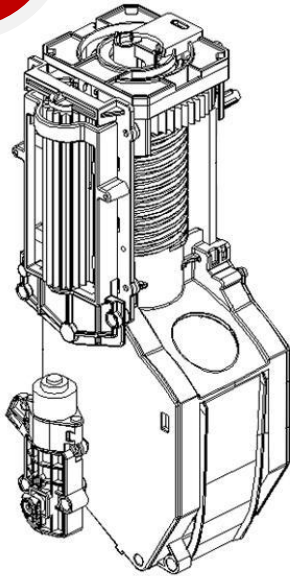

**Auto clean program  
no need disassemble**



**Accurate Tamping Process &  
Stable Pressure Control System**  
Provide guarantee of high quality espresso  
for every cup

05

## Professional tap water connection



Tap water connection  
for commercial occasions

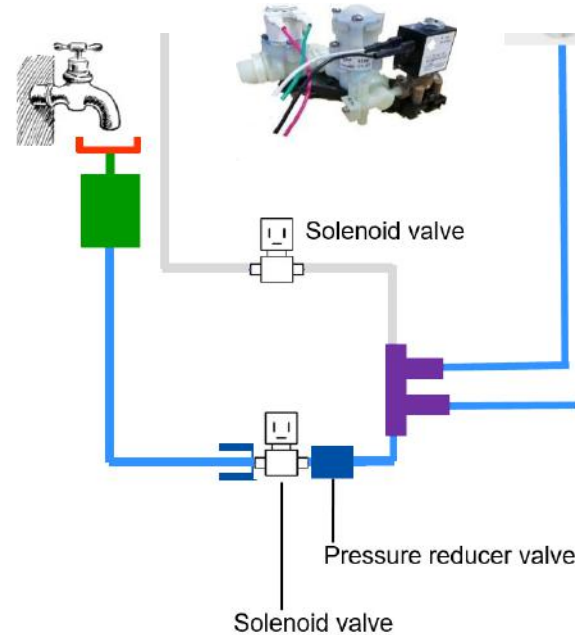

Reliable solenoid valve system

06

**Optional 6L large water tank and can fit with 150L water filter**



**6L large water tank  
ideal for big office**



**Optional filter connector for  
Swiss Aquis 150L water filter**



07

## Optional drainage pipe and auto slag-falling system

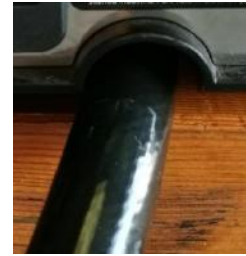
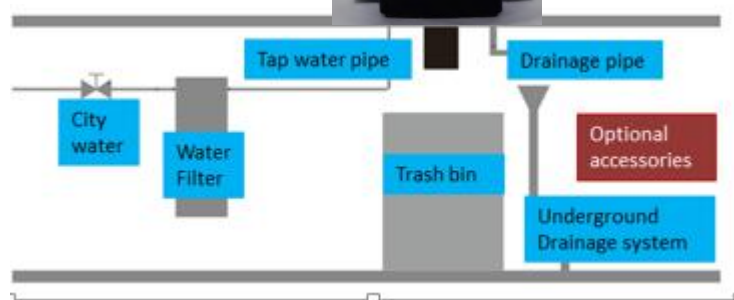

Drainage Pipe accessory

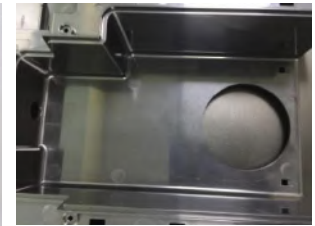

Auto slag-falling accessory

08

**Espresso cup support and optional single cup holder  
- Fit for various cup height from Espresso to Large Americano**



Espresso cup support



Single cup holder





03

**Product competition advantage**

# Product Competition Advantage



Model	JURA X8	Kalerm K95L
Photo		
Recommended max. daily cups	80	80
Pre-Brew	Yes	Yes
No. of pump	1	<b>2</b>
No. of thermo-block heating system	2	2
Fluid system	1	<b>2 ( make milk coffee more quickly)</b>
No. of Coffee specialties with one touch	21	<b>20+</b>
Display	3.5" TFT color screen with mechanical button	<b>7" LCD color touch screen</b>
Height-adjustable dual spout (Milk/Coffee)	65-153mm	80-165mm (with cup support)
Water tank capacity	5L	6L
Permanent water connection	No (optional accessory)	<b>Yes</b>
Filter	Yes	Yes
Powder chute for ground coffee	No	No

**K95L has better features than Jura X8, while the factory price is less than 1/2 of Jura X8**



04

## Product Series



# Product Series – K95

---



**K95 - Silver color**



**K95 - Black color**

**K100S (Fridge) -optional accessory**

# Product Series – K95L

---



**K95L - Black color**



**K95L - Silver color**

**K100S(Fridge) - optional accessory**

# Product Series – Accessories

---



## Standard Accessories



**Milk & milk foam  
Temperature adjuster**



**Auto fill-in pipe  
& connector**



**Espresso cup support**

## Optional Accessories

Drainage Pipe



Slag-falling Tunnel



150L Water Filter Connector



Single Cup Holder



## Optional Accessories

### MILK COOLER



ITEM	K180
Voltage	AC220V, DC12V
Rated Power	Cold mode: 40-52W Hot mode: 32-50W
Coloring	approx. 15 C below ambient temp.
Capacity	6L
Color	Black painted
N.W/G.W	3.4/4.0 kg
Product size(W*D*H)	213x275x343mm
Carton size(W*D*H)	235x290x375mm
Loading Quantity	20'/40'FCL: 1100/2200 units

### MINI FRIDGE



ITEM	K100S
Voltage	220-240V/50-60Hz
Rated Power	750W
Coloring	class 3: 0-4 C
Refrigerant	R600a (12g)
Capacity	6L
Color	Black powder coated
Forced Air cooling	≤ 8h
N.W/G.W	14.1/16.1 kg
Product size(W*D*H)	220x452x456mm
Carton size(W*D*H)	290x530x525mm
Loading Quantity	20'/40'FCL: 320/640 units





Suzhou Industrial Park Kalerm Electric Appliances Co., Ltd

THANKS  
FOR YOUR WATCHING